

**iroda**

**TG-600V  
GLUE GUN**

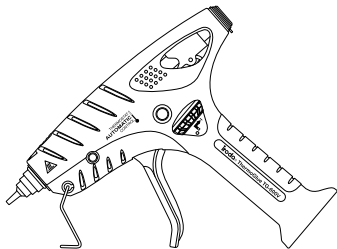

**Instruction Manual**

READ INSTRUCTIONS AND WARNINGS BEFORE USE

## IMPORTANT SAFETY INSTRUCTIONS

### Warnings:

- Read instructions before use.
- DO NOT refill, ignite or use near open flame, heater, furnace or combustible materials.
- KEEP AWAY FROM CHILDREN.
- Use only high-quality butane gas.
- Do not touch heated tip during use, or before sufficient time has passed for cooling.
- Always be sure the unit is cool before storing.
- Store properly when not in use.
- Keep in a dry place, out of the reach of children.
- DO NOT leave unit unattended when operating or hot.
- If your TG-600V malfunctions do not try to repair. Contact your dealer or online support for help.

2

## DESCRIPTION

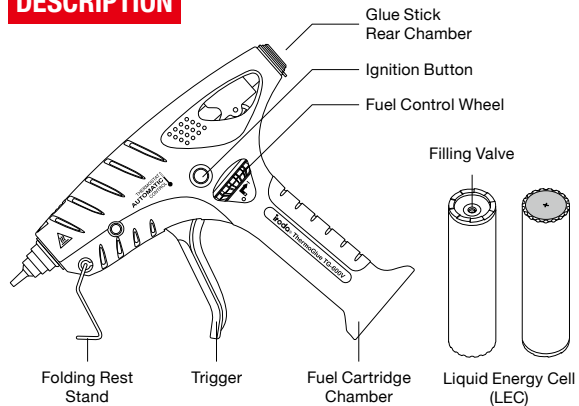

3

## HOW TO USE THE TG-600V

### REFILLING LEC (Liquid Energy Cell)

- Use only high-quality butane gas.
  - Refill in a well-ventilated area away from any ignition source and other people.
1. Hold butane canister upside down when filling (Fig. 1)
  2. Firmly press nozzle of butane fuel into the **Filling Valve** of the LEC.
  3. Stop filling when gas overflows. (Gas overflow during refilling is normal and does not indicate a leak)
  4. Wait for a few minutes before use for gas to stabilize.

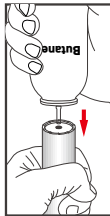

Fig.1

### INSERT LEC INTO TG-600V

1. Remove **Fuel Cartridge Chamber Cap** at bottom of TG-600V. (Fig. 2.1)
2. Insert LEC into chamber with **blue flat side toward inside of chamber**.
3. Replace Chamber Cap. (Fig. 2.2)

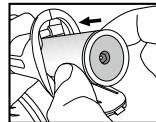

Fig.2.1

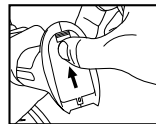

Fig.2.2

### INSERT GLUE STICK

1. Place glue stick in rear chamber. (Fig. 3)
2. Push forward until glue stick stops.
3. If using short sticks or for continuous use, insert 2 sticks, one behind the other.
4. Wait several minutes after inserting for glue to reach flow temperature.

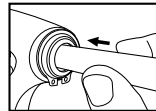

Fig.3

## ADVANCE GLUE STICK

- Pull **Trigger** back gently towards handle. (Fig. 4)

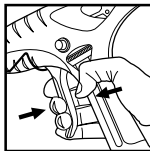

Fig.4

## TURN ON FUEL

- Push up **Fuel Control Wheel** and turn wheel to the right. (Fig. 5)

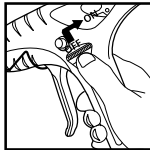

Fig.5

## IGNITE

1. Push red **Ignition Button** until ignited. (Fig. 6.1)
2. Tip will start to glow red. (Fig. 6.2)
3. Allow 3-5 minutes to allow glue to soften

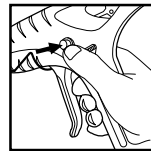

Fig.6.1

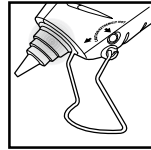

Fig.6.2

## DISPENSE GLUE

- Gently squeeze **Trigger** until desired amount of glue is dispensed. (Fig. 7)

## USING REST STAND

- Pull down metal **Folding Stand**. (Fig. 8)
- Position gun in stand when not actively using.

## TURN OFF UNIT

- Rotate **Fuel Control Wheel** (Fig. 9) left until the end and it snaps into locked position.
- To avoid clogging/dripping after use pull back the glue stick about 1".

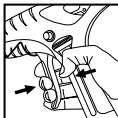

Fig.7

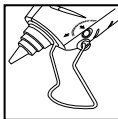

Fig.8



Fig.9

## NOTE

After the TG-600V cools and is used at a later time, it is normal for up to 1" of hardened glue to be dispensed before hot glue flows from nozzle.

## TROUBLE SHOOTING

- To reduce the risk of personal injury, property damage, or damage to your TG-600V, do not attempt to repair the unit body.

## SPECIAL WARNING

- This product, when used for soldering and similar applications, produces chemicals known to the State of California to cause cancer and birth defects or other reproductive harm.
- Department of Transportation Hazardous Materials Regulations forbid the carriage of butane or other flammable gas products on passenger aircraft. Do not pack this item or any other flammable gas item, in any checked or carry-on baggage.

## SPECIFICATIONS

Dimensions	Length	228 mm (9 inches)
	Width	48 mm (1.9 inches)
	Height	205 mm (8.1 inches)
Weight	Empty Tank	380 g (13.4 oz)
Fuel	Butane	
Operating Time	Mid Setting	Approx. 150 min.
Fuel Cartridge Capacity	1 oz (30 ml)	
Flame Temp	≈ 347~410 °F (175~210 °C)	



**WARNING**

-Read the instructions before using the appliance.

**CAUTION:**

-Accessible parts may be very hot. Keep young children  
away from the appliance.

 **iroda**

[www.pro-iroda.com](http://www.pro-iroda.com)