

# iroda®

## TURBO-LITE

Model AT-2060

### SPECIFICATIONS:

AT-2060 Butane Powered Turbo-Lite	
Out Body Meas	76 (H) x 22(W) x 33(L),mm
Weight (w / o fuel)	68 g (empty)
Fuel	Butane
Hours of nonstop Burning	30 Minutes
Flame Temperature	1300°C (blue flame)

### FEATURES:

- State of the art Piezo Electric Ignition system eliminates the need for matches and lighters.
- Wind-Proof flame and water proof ignition make the Turbo-Lite ideal for camping and outdoors.
- Compact size fits easily into any first aid/survival kit.
- Easy and inexpensive to refill by using normal butane gas.
- Adjustable flame for high or low temperatures. (See **C**)

### PLEASE READ ALL INSTRUCTIONS AND WARNINGS BEFORE MAKING USE OF THE TURBO-LITE.

### HOW TO USE TURBO-LITE:

- Push the nozzle cover lock. (See **A** - 'Push' button). To ignite the Turbo-Lite, slowly press the ignition button. Your Turbo-Lite is now fired up and ready to use.
- Upon refilling, turn the unit upside down and firmly push the butane can into the filling valve. The tank should be filled in seconds. Please allow a few minutes after filling for the gas to stabilize.
- If no flame appears, adjust the regulator on the filling valve by using chisel type screwdriver turning the filling valve to the clockwise or counterclockwise directions for an proper length of flame. (See **C**)
- To use continuously, switch the Flame Lock (**D**) to the Lock position after igniting. (**B**)

### WARNINGS:

- Read instructions before use.
- Do not ignite or use near an open flame, heater, furnace, or combustible material.
- Do not touch the flame cover during use, or before sufficient time has passed for cooling.
- Always be sure the unit is cool before storing.
- Store properly when not in use, switch the safety lock to the locked position. Keep in a dry place, out of the reach of children.
- Do not attempt to readjust or repair the Turbo-Lite. Unit is not user serviceable.
- Do not use continuously for more than five (5) minutes.

**Caution:** The torch flame is almost invisible in daylight, or in strong light.

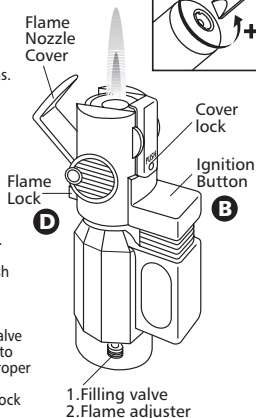
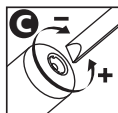
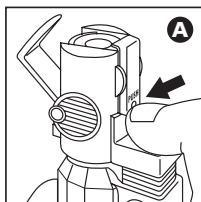

Taiwan

