

# iroda® TURBO-LITE®

Model AT-2056CR

## SPECIFICATIONS:

AT-2056CR Butane Powered Turbo-Lite	
Out Body Meas	76 (H) x 22(W) x 33(L)mm
Weight (w/o fuel)	48 g (empty)
Fuel	Butane
Hours of nonstop burning	30 Minutes
Flame Temperature	1300°C (blue flame)

## FEATURES:

- State of the art Piezo Electric Ignition system eliminates the need for matches and lighters.
- Wind-Proof flame and water proof ignition make the Turbo-Lite ideal for camping and outdoors.
- Compact size fits easily into any first aid/survival kit.
- Easy and inexpensive to refill by using normal butane gas.
- Adjustable flame for high or low temperatures. (See ③)

## PLEASE READ ALL INSTRUCTIONS AND WARNINGS BEFORE MAKING USE OF THE TURBO-LITE.

## HOW TO USE TURBO-LITE:

- To ignite the Turbo-Lite: **AT THE SAME TIME**, press tip of thumb against Cover Lock "A" while pushing down on Ignition Button "B". You must do both actions at the same time or Turbo-Lite will not ignite.
- To refill, turn the unit upside down and firmly push the butane can into the filling valve. The tank should be filled in seconds. Please allow a few minutes after filling for the gas to stabilize.
- If no flame appears, adjust the regulator on the filling valve by hand turning the filling valve to the clockwise or counterclockwise directions for an proper length of flame. (See ③)
- To use continuously, switch the Flame Lock (D) to the Lock position after igniting. (E)
- After use, push the Flame Nozzle Cover to lock and make sure that the "hands free" flame lock is in the off position.

## WARNINGS:

- Read instructions before use.
- Do not ignite or use near an open flame, heater, furnace, or combustible material.
- Do not touch the flame cover during use, or before sufficient time has passed for cooling.
- Always be sure the unit is cool before storing.
- Store properly when not in use, switch the safety lock to the locked position. Keep in a dry place, out of the reach of children.
- Do not attempt to readjust or repair the Turbo-Lite. Unit is not user serviceable.
- Do not use continuously for more than five (5) minutes.

**Caution: The torch flame is almost invisible in daylight, or in strong light.**

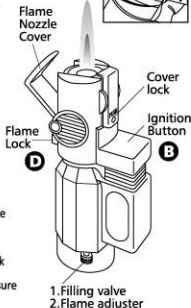
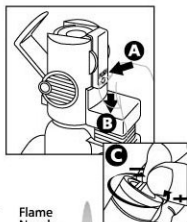
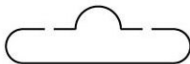

MADE IN TAIWAN